

Heavy Duty Inline Damper

Description

Metal Zinc's Inline Damper is constructed with a $\frac{3}{8}$ " aluminum square rod to the damper for the control of air in round ductwork systems.

Features

2" Standoff, controller with handle and wingnut with lock washer & $\frac{3}{8}$ " square rod.

Full metal blade & connections

Standard Construction

Manufactured using 26-gauge ASTM A653

Available dimensions are 4" to 16"

Optional Construction

Agion (antimicrobial coating)

Crimp & Bead

Stainless steel 304 and 306

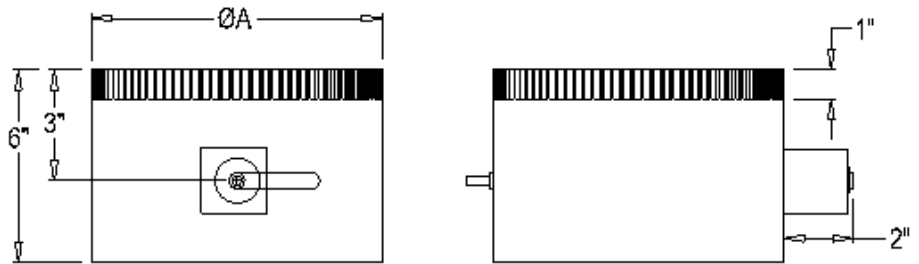

Packaging

Metal Zinc Part Number	Size A Inches	Row Quantity	Pallet Quantity
SF3995-EE	4	30	300
SF4000-EE	6	30	300
SF4010-EE	8	20	200
SF4020-EE	10	12	120
SF4030-EE	12	12	120
SF4040-EE	14	9	90
SF4050-EE	16	9	90